

- Grass and Wildflower Seeding Mixes**
- Mix A**
Standard Amenity Grassland Seed Mix at 25g/m²
Festuca rubra (Slender Creeping Red Fescue) 30%
Lolium perenne (Perennial Ryegrass) 25%
Poa pratensis (Smooth Stalked Meadow-grass) 20%
Agrostis capillaris (Tall Leaved White Clover) 5%
Triticum repens (Small Leaved White Clover) 5%
- Mix B**
Species Rich Neutral Grassland Seed Mix at 5g/m²
Cynodon dactylon (Crested Dogtail) 16%
Festuca rubra (Slender Creeping Red Fescue) 15%
Agrostis capillaris (Common Bent) 10.5%
Dactylis glomerata (Cocksfoot) 10.5%
Agrostis subarvensis (Creeping Bent) 5.5%
Agrostis pratensis (Meadow Foxtail) 5.5%
Deschampsia cespitosa (Tulied Hair-Grass) 5.5%
Tetradlea flavescens (Yellow Oak-Grass) 5.5%
Poa pratensis (Smooth-Stalked Meadow Grass) 5%
Ranunculus acris (Meadow Buttercup) 3%
Achillea millefolium (Yarrow) 2%
Centaurea nigra (Common Knapweed) 2%
Plantago lanceolata (Ribwort Plantain) 2%
Ranunculus repens (Creeping Buttercup) 2%
Ranunculus flammula (Yellow Rattle) 2%
Antoxanthum odoratum (Sweet Vernal Grass) 1%
Centaurea scaberrima (Greater Knapweed) 1%
Lactuca scariola (Black Lettuce) 1%
Plantago major (Peppercorn Plantain) 1%
Pumila vulgaris (Shepherd) 1%
- Mix C**
Marsh, Wet/Dry Grassland and Fen Seed Mix at 5g/m²
Actinella permaria (Greenwort) 1%
Agrostis capillaris (Common Bent) 12%
Antoxanthum pratense (Meadow Foxtail) 5%
Antoxanthum odoratum (Sweet Vernal-grass) 1%
Achillea millefolium (Yarrow) 0.5%
Bidens tripartita (Scribbler's Chicks) 0.4%
Centaurea nigra (Common Knapweed) 1%
Cynodon dactylon (Crested Dogtail) 32%
Festuca rubra (Red Fescue) 25%
Festuca ovina (Sheep Fescue) 0.2%
Glycerhiza acutiflora (Yellow Flag) 1%
Helianthus scaber (Yellow Flag) 8%
Leucanthemum vulgare (Great Daisy) 1.5%
Lolium perenne (Perennial Ryegrass) 1%
Lythrum salicaria (Purple Loosestrife) 1%
Plantago lanceolata (Ribwort Plantain) 1%
Primula veris (Cowslip) 1%
Ranunculus acris (Meadow Buttercup) 3%
Ranunculus minor (Yellow Rattle) 1.6%
Rumex acetosella (Common Sorrel) 1.2%
Sanguisorba officinalis (Great Burnet) 0.5%
Stellaria media (Peggy's Sandring) 1%
Stellaria media - (Lupinus fuscus) (Flagged Robin) 0.3%
Silene acaulis (Red Campion) 1%
Succisa pratensis (Dwarfish Scabious) 0.4%
Vicia cracca (Tulied Vetch) 2%
- Seed Mix D**
Improved Grassland Seed Mix sown at 4 g/m²
Agrostis capillaris (Highland Bent) 3%
Cynodon dactylon (Crested Dogtail) 9%
Dactylis glomerata (Cocksfoot) 9%
Festuca rubra (Strong-creeping Red-fescue) 12%
Lolium perenne (Perennial Ryegrass) 35%
Phleum bertolonii (Smaller Cat-tail) 6%
Poa pratensis (Smooth-stalked Meadow-grass) 9%
Schedonorus pratensis (Meadow Fescue) 12%
Triticum repens (Small Leaved White Clover) 2%
Trifolium pratense (Red Clover) 3%

FOR CONTINUATION,
 SEE DRAWING NO. 0006

FOR CONTINUATION,
 SEE DRAWING NO. 0012

FOR CONTINUATION,
 SEE DRAWING NO. 0008

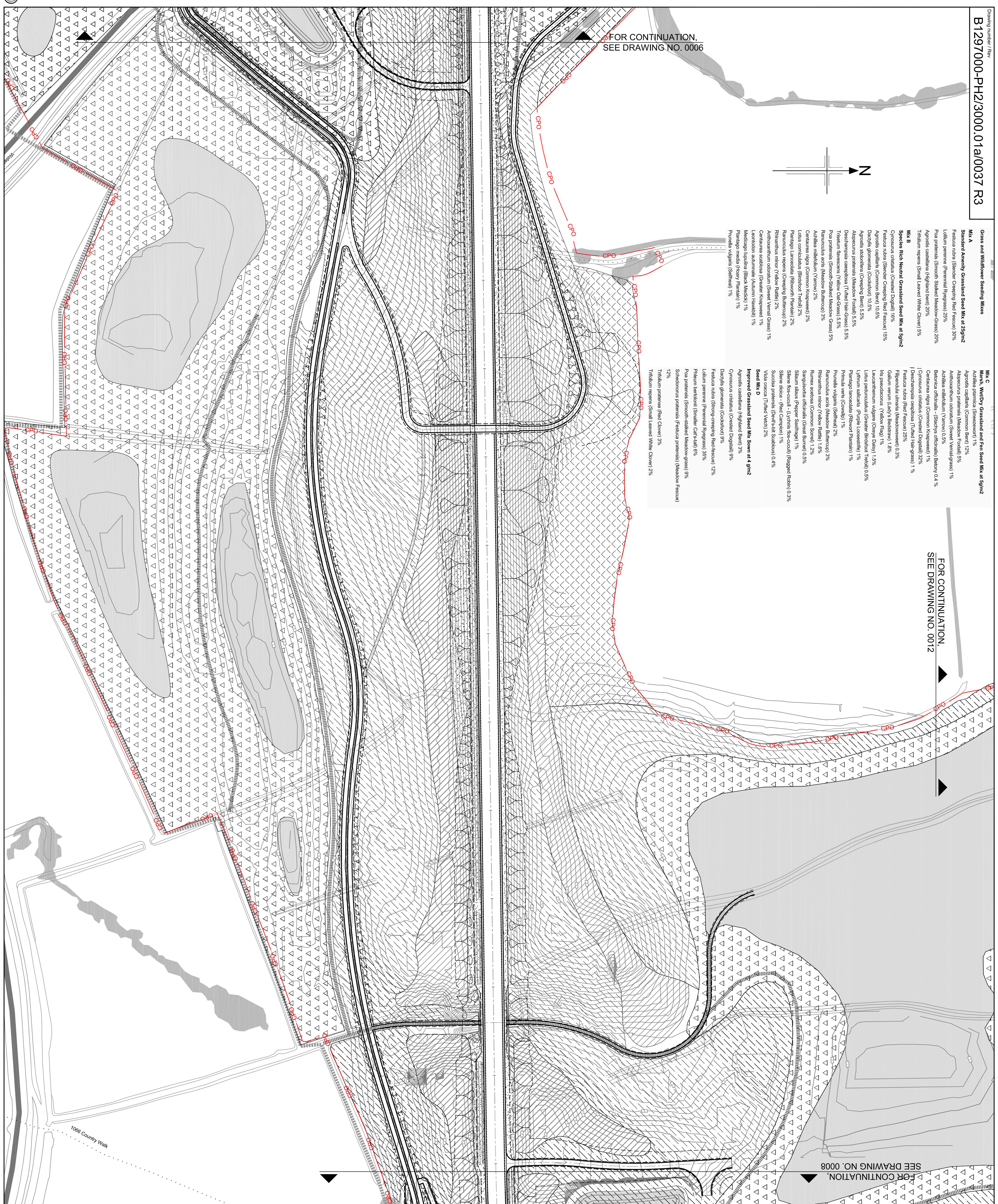

NOTES

- All dimensions in metres unless otherwise stated.
- KEY**
- Mix A (Standard amenity grass seed mix)
 - Mix B (Species rich neutral grassland)
 - Mix C (Open grassland suitable for badger foraging)
 - Mix D (Marsh, wet grassland and fen)
 - Mix E (Improved grassland)
 - 75mm deep composted bark mulch
 - Site of Special Scientific Interest (SSSI)
 - Site of Nature Conservation Importance (SNCI)
 - Ditch
 - Watercourse
 - Pond
 - Public Footpath
 - Byway
 - Railway
 - Existing trees to be retained
 - Finished ground within planting plots but outside the specified to be retained at least 3 times during each growing season to control the natural colonisation of herbaceous vegetation.

SAFETY HEALTH AND ENVIRONMENTAL INFORMATION

In addition to the following, the types of work detailed on this drawing, note the following:

CONSTRUCTION
 Lifting of heavy hazardous substances
 Existing overhead and underground high voltage cables
 Working adjacent to a railway/
 Working on slopes steeper than 1:3
 Working near to site plant and other machinery

MAINTENANCE / CLEANING
 Same as for construction

DECOMMISSIONING / DEMOLITION
 Same as for construction

REPRODUCTION FROM THE ORDINANCE SURVEY MAP WITH THE PERMISSION OF THE CONTROLLER OF HER MAJESTY'S STATIONERY OFFICE. CROWN COPYRIGHT RESERVED. LICENCE NO. AL 100017326

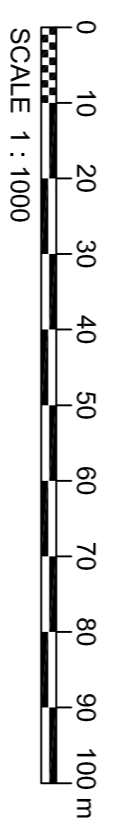

Rev	Rev. Date	Purpose of revision	Drawn	Checked	Rev'd	Apprv'd
R3	28/02/2013	GREENWAY AMENDED AT HILLCROFT	ASC	RNS	SSG	RND
R2	08/01/2013	PLANTING SEEDING REMOVED	EH	AS	AS	AB
R1	13/12/2012	CHANGES TO SEED MIXES	AS	ES	ES	AB
R0	18/10/2012	INITIAL ISSUE	RM	ES	AS	AB

Client: **HOCHTIEF** **TEVA** **WATERBURY**

Employer: **JACOBS**

Project: **BEXHILL TO HASTINGS LINK ROAD**

Drawing title: **SEEDING SHEET 7 OF 13**

Drawing status: **ISSUE FOR REVIEW**

Scale: 1:1000 @ A1
 Jacobs No. B1297000
 Client no. B1297000
 Drawing number: **B1297000-PH2/3000.01a/0037 R3**

This drawing is not to be used in whole or part other than for the intended purpose and project as defined on this drawing. Refer to the contract for full terms and conditions.